



# ANLY CONTROLLER

## ACR CURRENT RELAY



### CHARACTERISTIC :

- Customized CMOS IC for low power consumption, high operation stability and extreme timing accuracy
- Wide range current range (2A ~ 7A)
- LED status indicator for easy over current monitoring
- Surface mount and flush mount possible

### SPECIFICATION :

|                                   |  |
|-----------------------------------|--|
| Operating voltage                 | AC/DC(V): 100 - 240                                      |
| Allowable operating voltage range | 85~110% of rated operating voltage                       |
| Rated frequency                   | 50 / 60 Hz   |
| Detecting method                  | Detect supply current                                    |
| Setting current                   | AC 1 ~ 3.5A or AC 2 ~ 7A                                 |
| Compensating time at starting     | ACR-N: 1S, ACR-NT: 0~30S                                 |
| Reset time                        | MAX 0.05S  |
| Contact rating                    | 250VAC 5A (resistive load)                               |
| Power consumption                 | Approx. 2VA  |
| Life                              | Mechanical: 5,000,000 times<br>Electrical: 100,000 times |
| Ambient temperature               | -10 ~ +50°C (without condensation & freezing)            |
| Ambient humidity                  | MAX 85%RH (without condensation)                         |
| Altitude                          | MAX 2000m  |
| Weight                            | Approx. 106g   |

### TYPE SELECTION :

| Type           | ACR-N             | ACR-NT |
|----------------|-------------------|--------|
| Output contact | 1A,1B             | 1C     |
| Setting range  | 1 ~ 3.5A , 2 ~ 7A |        |

## CONNECTION :

ACR-N

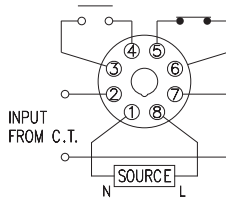

ACR-NT

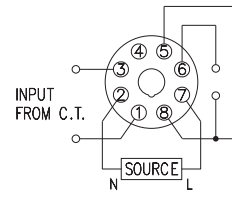

## TIMING CHART :

ACR-N

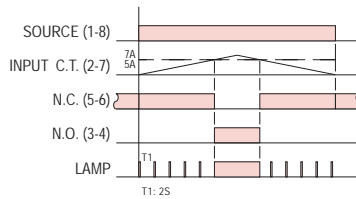

ACR-NT

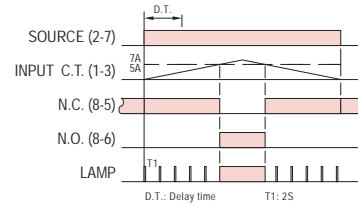

## DIMENSIONS : (mm)

N type(Surface Mounting): Using 8PFA Socket

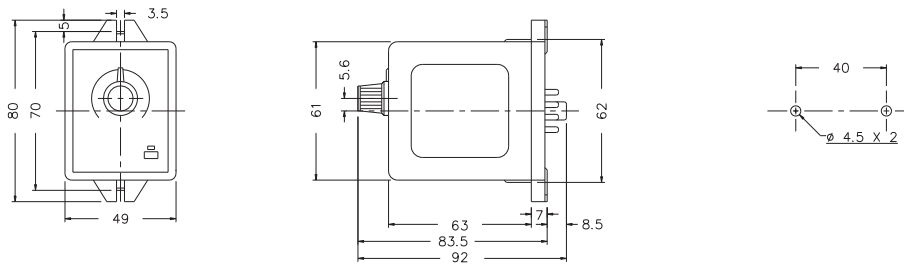

Y type(Flush Mounting): Using US-08 Socket or P3G-08 Socket

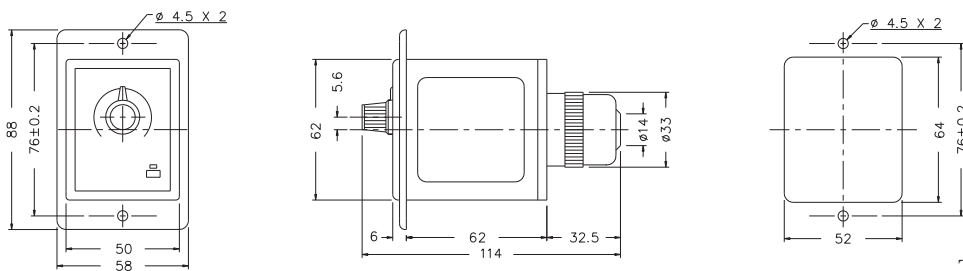

Tolerance:±0.1

**ANLY ELECTRONICS CO., LTD.**

<http://www.anly.com.tw>

**TAIWAN MAIN OFFICE : ANLY ELECTRONICS CO., LTD.**

No.19, Lane 202, Fushou St., Xinzhuang Dist., New Taipei City 242, Taiwan  
TEL: +886-2-2996-3202 FAX: +886-2-2996-2017

**HONG KONG OFFICE : ANLY ELECTRONICS (HK) LTD.**

Flat K, 13/F, Edward Mansion, 141 Prince Edward Road W., Kowloon, Hong Kong  
TEL: +852-2397-2505 FAX: +852-2397-6080

**CHINA OFFICE : ANLY TECHNOLOGY (WUXI) CO., LTD.**

2F, Building A, Plot 1, No. 28, Zhanhong Rd., Xinwu Dist., Wuxi, Jiangsu, P.R.China  
TEL: +86-510-85304801-3

**MALAYSIA OFFICE : JUSTY ELECTRONICS (M) SDN. BHD.**

No.1, Jalan 6/89B, Kawasan Perindustrian Trisegi, Batu 3 1/2 Off Jalan Sungei Besi, 57100 Kuala Lumpur, Malaysia  
TEL: +60-3-7983-5758 FAX: +60-3-7981-5052

**INDONESIA OFFICE : PT. ANLY ELECTRONICS INDONESIA**

Jl. Pangeran Jayakarta 117/B9, Jakarta Pusat, 10730 Indonesia  
TEL: +62-21-624-8436 FAX: +62-21-626-1228

NO. ACR-W-B