



# ANLY TIMER

## ASTP ANALOGUE TIMER



### CHARACTERISTIC :

- Customized CMOS IC for low power consumption, high operation stability and extreme timing accuracy
- 15 different time ranges available, from 0.1S to 24H
- CE certified

### SPECIFICATION :

Operating voltage	DC(V): 12, 24 AC(V): 12, 24, 110, 220, 240
Allowable operating voltage range	85~110% of rated operating voltage
Rated frequency	50 / 60 Hz
Contact rating	250VAC 5A (resistive load)
Reset time	MAX 0.1S
Power consumption	Approx. 3VA
Life	Mechanical: 5,000,000 times Electrical: 100,000 times
Ambient temperature	-10 ~ +50°C (without condensation & freezing)
Ambient humidity	MAX 85% RH (without condensation)
Altitude	MAX 2000m
Weight	Approx. 220g

### TYPE SELECTION :

Type	ASTP-N1 / Y1	ASTP-N2 / Y2	ASTP-N / Y
Output contact	1C	2C Delayed	2C Inst.+Delayed
Time range	1 , 2 , 6 , 12 , 30 , 60 or 180S		
	6 , 12 , 30 or 60M		
	3 , 6 , 12 or 24H		

## CONNECTION :

1C

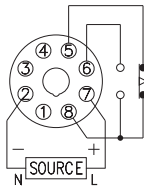

2C Delayed

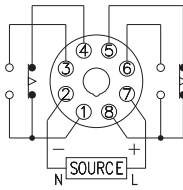

2C Inst.+Delayed

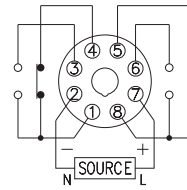

## TIMING CHART :

1C

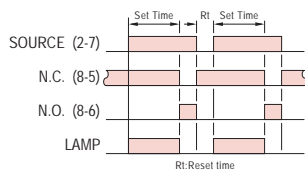

2C Delayed

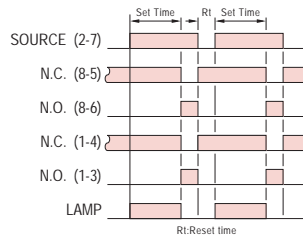

2C Inst.+Delayed

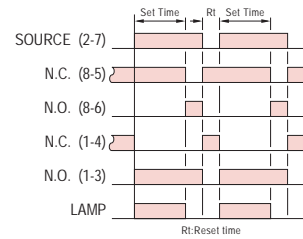

## DIMENSIONS : (mm)

N type(Surface Mounting): Using 8PFA Socket

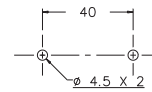
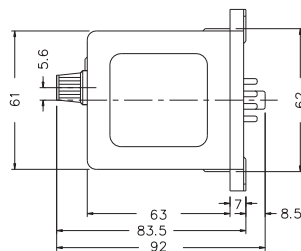
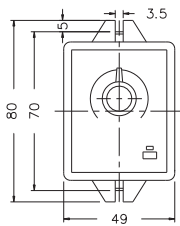

Y type(Flush Mounting): Using US-08 Socket or P3G-08 Socket

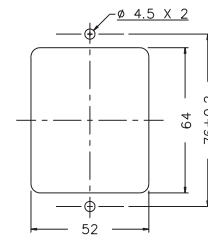
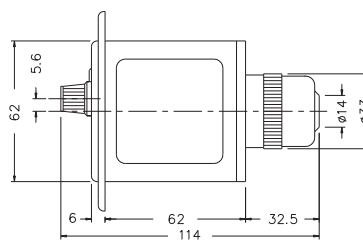
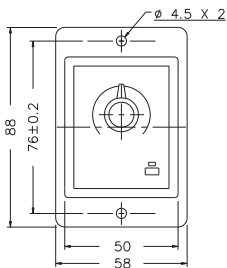

Tolerance:±0.1

**ANLY ELECTRONICS CO., LTD.**

<http://www.anly.com.tw>

**TAIWAN MAIN OFFICE : ANLY ELECTRONICS CO., LTD.**

No.19, Lane 202, Fushou St., Xinzhuang Dist., New Taipei City 242, Taiwan  
TEL: +886-2-2996-3202 FAX: +886-2-2996-2017

**HONG KONG BRANCH : ANLY ELECTRONICS (HK) LTD.**

Flat K, 13/F, Edward Mansion, 141 Prince Edward Road W., Kowloon, Hong Kong  
TEL: +852-2397-2505 FAX: +852-2397-6080

**SHANGHAI BRANCH : ANLY TECHNOLOGY (WUXI) CO., LTD.**

Room 13G, No.831, Xinzha Rd., Jingan District, Shanghai, China 200041  
TEL: +86-21-6218-3300 FAX: +86-21-6217-5911

**MALAYSIA BRANCH : JUSTY ELECTRONICS (M) SDN. BHD.**

No.1, Jalan 6/89B, Kawasan Perindustrian Trisegi, Batu 3 1/2 Off Jalan Sungai Besi, 57100 Kuala Lumpur, Malaysia  
TEL: +60-3-7983-5758 FAX: +60-3-7981-5052

**INDONESIA BRANCH : PT. ANLY ELECTRONICS INDONESIA**

Jl. Pangeran Jayakarta 117/B9, Jakarta Pusat, 10730 Indonesia  
TEL: +62-21-624-8436 FAX: +62-21-626-1228

NO. ASTP-S-A