



# ANLY TIMER

ANLY

## ATDH TWIN ANALOGUE TIMER FOR MISTING PUMP



### CHARACTERISTIC :

- Customized CMOS IC for low power consumption, high operation stability and extreme timing accuracy
- Independent adjustment for continuous ON-OFF operation and time
- Separate pressure-release timing , adjustable from 2S~15S
- Adjustable pressure-release time
- 16 different time ranges available
- 2 operating voltage in a single unit, AC110V and 220V
- 5(A, B, C, D, E) timing series available
- Each timing series has 4 time ranges, selectable via DIP switch

### SPECIFICATION :

Operating voltage	AC(V): 110, 220
Allowable operating voltage range	85~110% of rated operating voltage
Rated frequency	50 / 60 Hz
Contact rating	250VAC 5A (resistive load)
Reset time	MAX 0.2sec
Power consumption	Approx. 3VA
Life	Mechanical: 5,000,000 times Electrical: 100,000 times
Ambient temperature	-10 ~ +50°C (without condensation & freezing)
Ambient humidity	MAX 85% RH (without condensation)
Altitude	MAX 2000m
Weight	Approx. 235g

### TYPE SELECTION :

Model	Multi-Range Variable				
Output contact	1C				
Type	ATDH-NA / YA	ATDH-NB / YB	ATDH-NC / YC	ATDH-ND / YD	ATDH-NE / YE
Time range	1S / 10S / 1M / 10M	3S / 30S / 3M / 30M	6S / 60S / 6M / 60M	1M / 10M / 1H / 10H	3M / 30M / 3H / 30H

## CONNECTION :

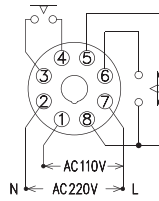

## TIMING CHART :

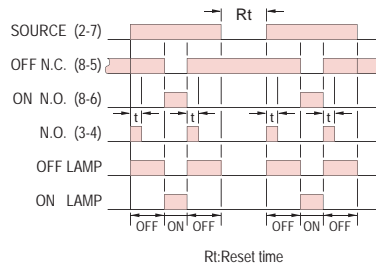

## DIMENSIONS : (mm)

N type(Surface Mounting): Using 8PFA Socket

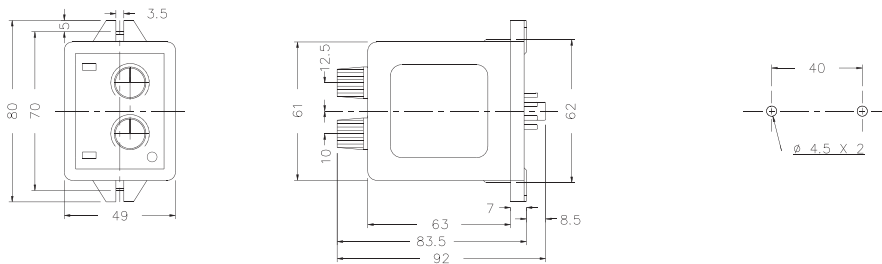

Y type(Flush Mounting): Using US-08 Socket or P3G-08 Socket

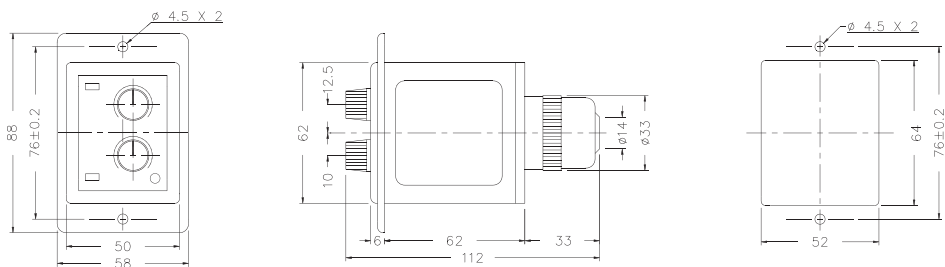

Tolerance:±0.1

## ANLY ELECTRONICS CO., LTD.

<http://www.anly.com.tw>

### TAIWAN MAIN OFFICE : ANLY ELECTRONICS CO., LTD.

No.19, Lane 202, Fushou St., Xinzhuang Dist., New Taipei City 242, Taiwan  
TEL: +886-2-2996-3202 FAX: +886-2-2996-2017

### HONG KONG OFFICE : ANLY ELECTRONICS (HK) LTD.

Flat K, 13/F, Edward Mansion, 141 Prince Edward Road W., Kowloon, Hong Kong  
TEL: +852-2397-2505 FAX: +852-2397-6080

### CHINA OFFICE : ANLY TECHNOLOGY (WUXI) CO., LTD.

2F, Building A, Plot 1, No. 28, Zhanhong Rd., Xinwu Dist., Wuxi, Jiangsu, P.R.China  
TEL: +86-510-85304801~3

### MALAYSIA OFFICE : JUSTY ELECTRONICS (M) SDN. BHD.

No.1, Jalan 6/89B, Kawasan Perindustrian Trisegi, Batu 3 1/2 Off Jalan Sungei Besi, 57100 Kuala Lumpur, Malaysia  
TEL: +60-3-7983-5758 FAX: +60-3-7981-5052

### INDONESIA OFFICE : PT. ANLY ELECTRONICS INDONESIA

Jl. Pangeran Jayakarta 117/B9, Jakarta Pusat, 10730 Indonesia  
TEL: +62-21-624-8436 FAX: +62-21-626-1228

NO. ATDH-W-A