



ANLY TIMER

ATDV TWIN ANALOGUE TIMER



CHARACTERISTIC :

- Customized CMOS IC for low power consumption, high operation stability and extreme timing accuracy
- Independent adjustment for continuous ON-OFF operation and time
- 16 different time ranges available
- 2 operating voltage in a single unit, AC110V and 220V
- 5(A, B, C, D, E) timing series available*
- Each timing series has 4 time ranges, selectable via DIP switch*
- CE certified

Note: "*" indicates applicable to ATDV multi range series only

SPECIFICATION :

Operating voltage	DC(V): 12, 24 AC(V): 12, 24, 110, 220, 240
Allowable operating voltage range	85~110% of rated operating voltage
Rated frequency	50 / 60 Hz
Contact rating	250VAC 5A (resistive load)
Reset time	MAX 0.2S
Power consumption	Approx. 2VA
Life	Mechanical: 5,000,000 times Electrical: 100,000 times
Ambient temperature	-10 ~ +50°C (without condensation & freezing)
Ambient humidity	MAX 85% RH (without condensation)
Altitude	MAX 2000m
Weight	Approx. 220g

TYPE SELECTION :

Model	Variable	Multi-Range Variable		
Operating voltage	As specification shown	110V / 220V		
Output contact	1C	1C		
Type	ATDV-N / Y	ATDV-NA / YA	ATDV-NB / YB	ATDV-NC / YC
Time range	6S x 6S , 6S x 60S , 60S x 6S , 6M x 6M , 6M x 60M , 60M x 6M or 60M x 60M	1S / 10S / 1M / 10M	3S / 30S / 3M / 30M	6S / 60S / 6M / 60M
Type	- - - -	ATDV-ND / YD	ATDV-NE / YE	
Time range	Upon clients' request, up to 12H	1M / 10M / 1H / 10H	3M / 30M / 3H / 30H	

CONNECTION :

ATDV-N,Y

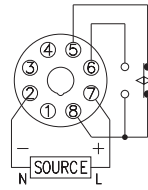

ATDV-□□

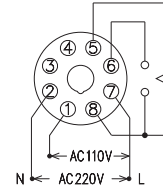

TIMING CHART :

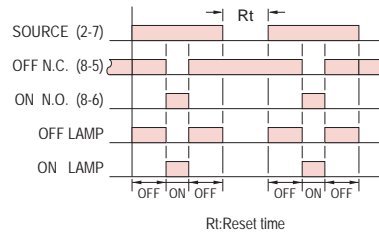

DIMENSIONS : (mm)

N type(Surface Mounting): Using 8PFA Socket

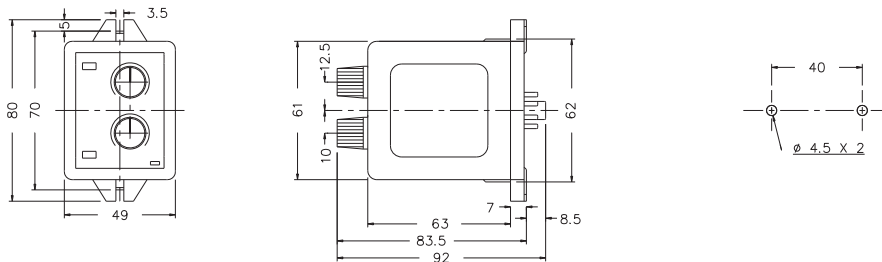

Y type(Flush Mounting): Using US-08 Socket or P3G-08 Socket

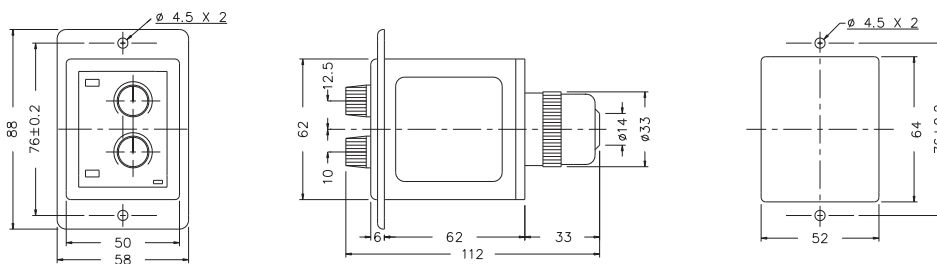

Tolerance:±0.1

ANLY ELECTRONICS CO., LTD.

<http://www.anly.com.tw>

TAIWAN MAIN OFFICE : ANLY ELECTRONICS CO., LTD.

No.19, Lane 202, Fushou St., Xinzhuang Dist., New Taipei City 242, Taiwan
TEL: +886-2-2996-3202 FAX: +886-2-2996-2017

HONG KONG OFFICE : ANLY ELECTRONICS (HK) LTD.

Flat K, 13/F, Edward Mansion, 141 Prince Edward Road W., Kowloon, Hong Kong
TEL: +852-2397-2505 FAX: +852-2397-6080

CHINA OFFICE : ANLY TECHNOLOGY (WUXI) CO., LTD.

2F, Building A, Plot 1, No. 28, Zhanhong Rd., Xinwu Dist., Wuxi, Jiangsu, P.R.China
TEL: +86-510-85304801~3

MALAYSIA OFFICE : JUSTY ELECTRONICS (M) SDN. BHD.

No.1, Jalan 6/89B, Kawasan Perindustrian Trisegi, Batu 3 1/2 Off Jalan Sungei Besi, 57100 Kuala Lumpur, Malaysia
TEL: +60-3-7983-5758 FAX: +60-3-7981-5052

INDONESIA OFFICE : PT. ANLY ELECTRONICS INDONESIA

Jl. Pangeran Jayakarta 117/B9, Jakarta Pusat, 10730 Indonesia
TEL: +62-21-624-8436 FAX: +62-21-626-1228

NO. ATDV-W-A