



ANLY TIMER

ATF OFF DELAY TIMER



CHARACTERISTIC :

- Off delay timer with adjustable time range
- Delay time up to 60min
- External manual reset available
- Instantaneous + Delayed contacts model available
- CE certified

SPECIFICATION :

Operating voltage	DC(V): 12, 24 AC(V): 12, 24, 110, 220, 240
Allowable operating voltage range	85~110% of rated operating voltage
Rated frequency	50 / 60 Hz
Contact rating	250VAC 5A (resistive load)
Reset time	MAX 0.3s
Power consumption	Approx. 3VA
Life	Mechanical: 5,000,000 times Electrical: 100,000 times
Ambient temperature	-10 ~ +50°C (without condensation & freezing)
Ambient humidity	MAX 85% RH (without condensation)
Altitude	MAX 2000m
Weight	Approx. 225g

TYPE SELECTION :

Output contact	Delayed (1C)	Delayed (2C)	Instantaneous + Delayed (2C)	Power-on time	Contact rating
Type	ATF-NF / YF	ATF-NF2 / YF2	ATF-NF4 / YF4	3s~10m(0.5s以上) 30m~60m(1s以上)	250VAC 5A
Manual reset	Contact input(1-4)	----	----		
Time range	3s, 6s, 10s, 30s, 60s, 3m, 10m, 30m, 60m				

CONNECTION :

1C

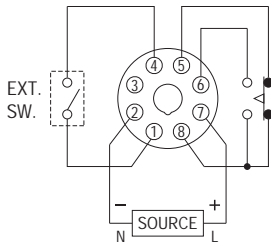

2C

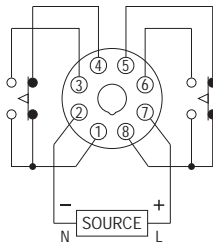

Instantaneous + Delayed (2C)

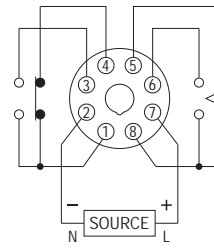

TIMING CHART :

1C

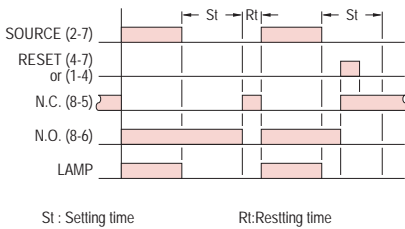

St : Setting time Rt: Resting time

2C

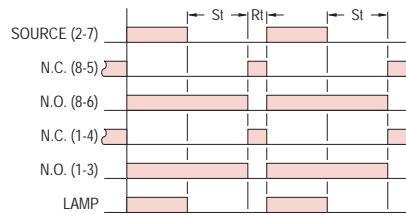

St : Setting time Rt: Resting time

Instantaneous + Delayed (2C)

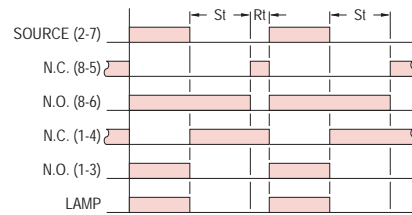

St : Setting time Rt: Resting time

DIMENSIONS : (mm)

N type(Surface Mounting): Using 8PFA Socket

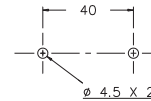
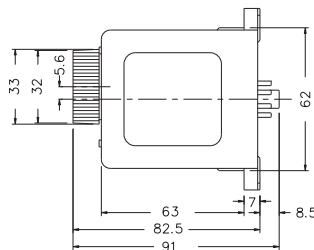
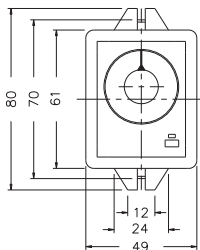

Y type(Flush Mounting): Using US-08 Socket or P3G-08 Socket

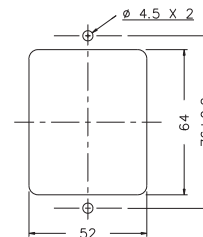
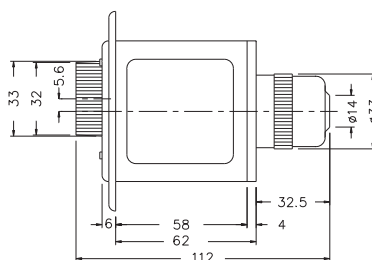
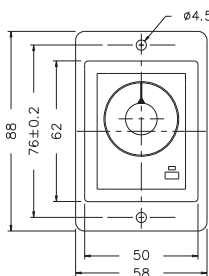

ONLY ELECTRONICS CO., LTD.

<http://www.ONLY.com.tw>

TAIWAN MAIN OFFICE : ONLY ELECTRONICS CO., LTD.

No.19, Lane 202, Fushou St., Xinzhuang Dist., New Taipei City 242, Taiwan
TEL: +886-2-2996-3202 FAX: +886-2-2996-2017

MALAYSIA BRANCH : JUSTY ELECTRONICS (M) SDN, BHD.

No.1, Jalan 6/89B, Kawasan Perindustrian Trisegi, Batu 3 1/2 Off Jalan Sungei Besi, 57100 Kuala Lumpur, Malaysia
TEL: +60-3-7983-5758 FAX: +60-3-7981-5052

HONG KONG BRANCH : ONLY ELECTRONICS (HK) LTD.

Flat K, 13/F, Edward Mansion, 141 Prince Edward Road W., Kowloon, Hong Kong
TEL: +852-2397-2505 FAX: +852-2397-6080

SHANGHAI BRANCH : ONLY TECHNOLOGY (WUXI) CO., LTD.

Room 13G, No.831, Xinzha Rd., Jingan District, Shanghai, China 200041
TEL: +86-21-6218-3300 FAX: +86-21-6217-5911

NO. ATF-R-A